



KAVISHA
ATRIA

2 & 3 BHK LIVING & SHOPS



WE ARE BORN TO BUILD



BORNTOBUILD!

KAVISHA GROUP IS A
PRIVATELY HELD BUILDING CONSTRUCTION FIRM
BASED IN AHMEDABAD

INCEPTED IN 1999 BY MR. RAMESH K. PATEL THE COMPANY HAS BEEN
CREATING BENCHMARKS AND CATERING TO A BROAD SPECTRUM OF
CUSTOMERS, GARNERING EXPERIENCE AND INSIGHTS.

STARTING WITH THE BUSINESS OF LAND DEALING, THE GROUP FORAYED
IN REAL ESTATE DEVELOPMENT ACTIVITIES SINCE 1999 AND IN SPAN OF
OVER 2 DECADES; THE GROUP HAS ACHIEVED HEALTHY PROGRESS
WITH PROJECTS ALREADY COMPLETED AND UNDER EXECUTION
INVOLVING AREA UNDER DEVELOPMENT OF MORE THAN 27 LACS+ SQ.FT.

THE GROUP POSSESSES A FULLY INTEGRATED PROPERTY DEVELOPMENT
TEAM CONSISTING OF EXPERIENCED ARCHITECTS, ENGINEERS AND
CONSULTANTS WHO OVERSEE THE DEVELOPMENT OF SPACES FROM
INCEPTION TILL THE COMPLETION.

"WHAT SET KAVISHA GROUP APART IS OUR QUALITY-CENTRIC APPROACH
AND A NEW CHANGE THROUGH THINKING DIFFERENTLY."

THE GROUP BELIEVES IN OFFERING HIGH QUALITY AT AFFORDABLE
PRICE, BY ATTAINING HIGH STANDARD OF ENGINEERING EXCELLENCE
AND QUALITY FOR WORKMANSHIP, SO AS TO MAXIMIZE THE
CUSTOMERS' SATISFACTION. WE STEADILY AIM TO REMAIN IN TREND
WITH NEW INNOVATIVE SPACE PLANNING, UPDATED CONSTRUCTION
TECHNOLOGY AND SELECTING NEW MATERIALS.

KAVISHA GROUP OFFERS A CHARMING BLEND OF AN EXCEPTIONAL LIFESTYLE & A WELL-CONNECTED LIFE SPACE AT 'KAVISHA ATRIA' WITH THE BEST OF CONTEMPORARY LIFE SPACES & AMENITIES THAT ENSURES A WARM AND LUXURIOUS LIFESTYLE AT A FINE ADDRESS. THE VIBRANT SURROUNDINGS, EXTREMELY HIGH-QUALITY CONSTRUCTION STANDARDS AND ACCESSIBILITY, SETS KAVISHA ATRIA AS THE PERFECT HOME FOR MODERN FAMILIES. WIDE OPEN SPACES, WELL PLANNED LANDSCAPES, AND PLUS SIZE HOMES. ITS EVERYTHING THAT YOU EVER WANTED AS YOUR DREAM HOME.

AN EXTRAORDINARY LIFE, A VIBRANT LIFESTYLE





CRAFTED FOR FINESSE

KAVISHA ATRIA'S ARCHITECTURAL DESIGN EFFORTLESSLY COMPLIMENTS ITS PRISTINE SURROUNDINGS. IT'S A SPACE WHERE NATURE AND CREATIVE INTELLIGENCE ARE WEAVED TOGETHER TO DEVELOP A PERSONAL SPACE FOR YOU AND YOUR LOVED ONES, A SPACE THAT IS ELEGANT AND FUNCTIONAL. EACH OF THE PREMIUM PLUS SIZE APARTMENTS AT KAVISHA ATRIA ARE CRAFTED WITH EXCLUSIVE AMENITIES THAT ENSURE A HAPPY & COMFORTABLE LIFESTYLE.



HARNESSING THE POWER OF SUN



WE BELIEVE THAT LIFE MUST EXIST ALONGSIDE NATURE & NOT AT THE COST OF IT. THIS IS AN ETHOS WE CALL CONSCIOUS LIVING. WITH ALL OUR UPCOMING PROJECTS WE TRY TO CONSERVE AS MUCH ENERGY WE CAN & INSTEAD HARNESS THE ABUNDANT SOLAR ENERGY TO CREATE A MORE SUSTAINABLE PRESENCE. KAVISHA ATRIA IS AN EXAMPLE OF OUR COMMITMENT TO THIS ENDEAVOUR. WITH SMART LIGHT FITTINGS, PROPER PLANNING & CONSCIOUS CALLS, WE ARE MOVING TOWARDS A GREENER & CLEANER TOMORROW WITH EACH PASSING DAY.



NOT JUST A BALCONY, IT'S YOUR PERSONAL SPACE OF POSSIBILITIES

TO ENSURE THAT YOU MAKE THE MOST OF THE FRESH AIR & EXPERIENCE QUALITY TIME, SWITCHING OFF FROM THE DAILY GRIND, WE HAVE CREATED AN EXTENDED BALCONY/SEATING SPACE IN EVERY ROOM, WHERE YOU CAN SIT BACK AND RELAX WITH YOUR LOVED ONES. MAKE IT YOUR THINKING PAD OR A CREATIVE ZONE, OR SIMPLY ENJOY THE VIEW FROM IT WITH YOUR FAVOURITE BOOK & BEVERAGE. ITS YOUR OWN PERSONAL HEAVEN & IS MADE TO MAKE YOUR 'EVERYDAY' A GREAT DAY.

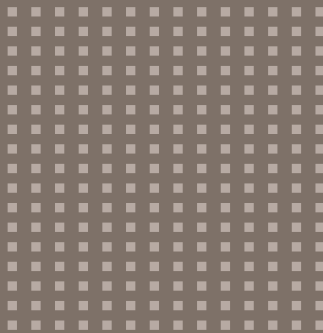



SWIMMING POOL



SOLAR POWERED UTILITIES



JOGGING TRACK



GYM



LANDSCAPE GARDEN



CLUB HOUSE



YOGA DECK



MULTIPURPOSE HALL & UTILITY AREA



INDOOR GAMES



CHILDREN PLAY AREA



DESIGNED FOYER



ALLOTTED PARKING



SENIOR CITIZEN SITOUT



24 HRS WATER



CCTV SURVEILLANCE



FIRE SAFETY

YOUR WELLBEING IS OUR KEY PREROGATIVE

WE BELIEVE IN MAKING SPACES THAT FILL EVERY DAY WITH MOMENTS OF JOY, FOR YOU AND YOUR LOVED ONES. ENSURING REFRESHING GREENERY AND AESTHETIC SURROUNDINGS TO LIFT YOUR SPIRIT, KAVISHA ATRIA BRINGS TO YOU THE FINEST INFRASTRUCTURE WITH WELL-PLANNED AMENITIES. YOUR QUEST FOR THE PERFECT HOME & AN EXUBERANT LIFESTYLE ENDS HERE.



THE CONCEPT OF BETTER LIVING



GROUND FLOOR

KAVISHA
ATRIA
2 & 3 BHK LIVING & SHOPS



18.00 MT. WIDE ROAD

FIRST FLOOR



SECOND FLOOR



3,5,7,9,11,13 FLOOR

4,6,8,10,12,14 FLOOR

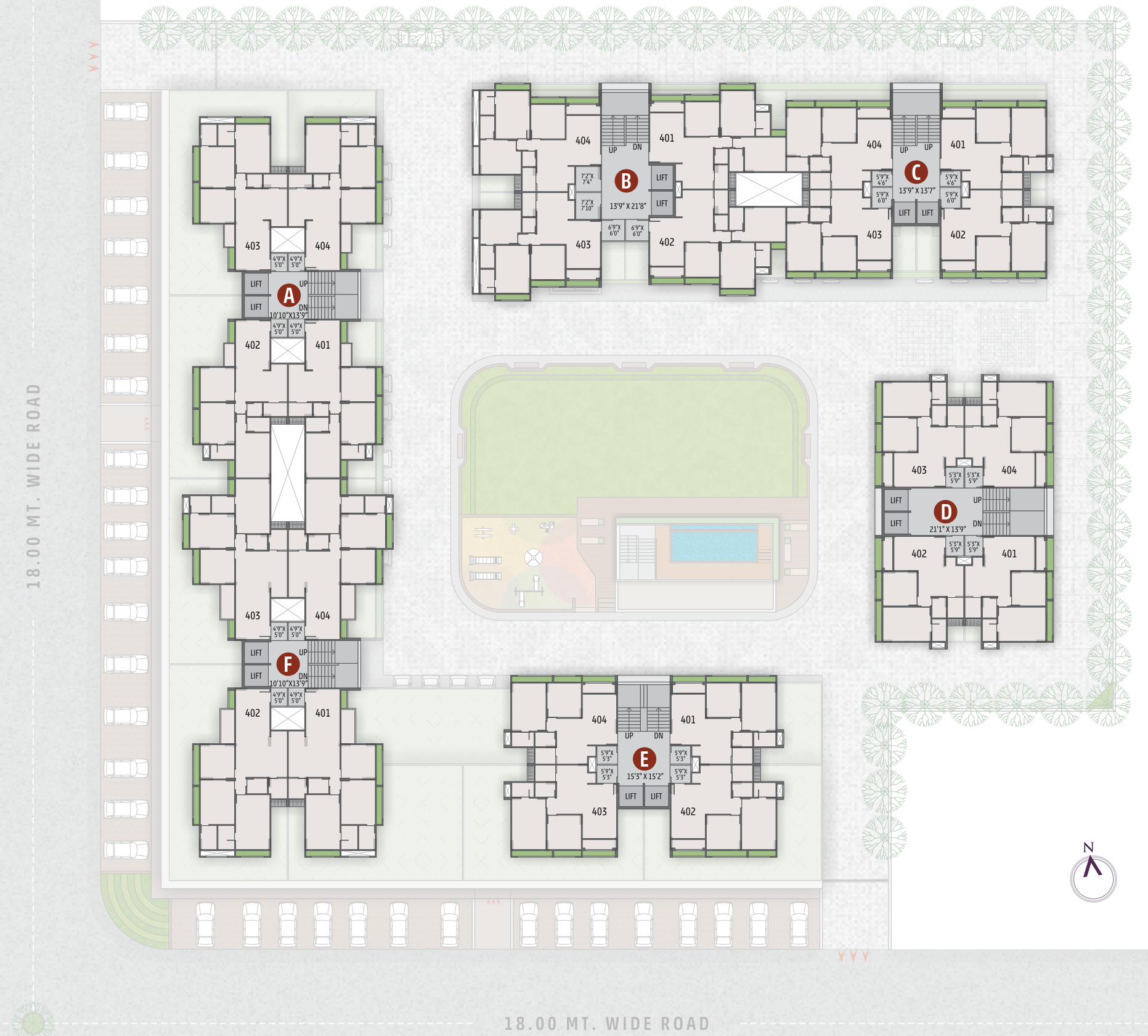

2 BHK
UNIT - A

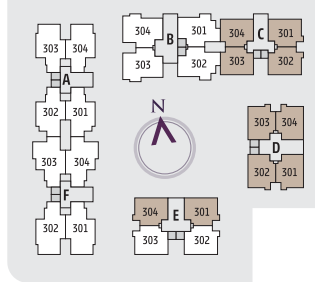

3 BHK
UNIT - A

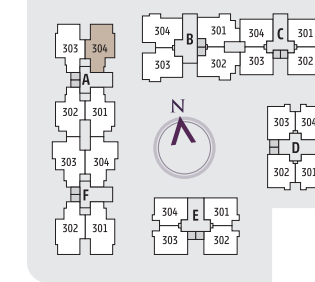

2 BHK
UNIT - B

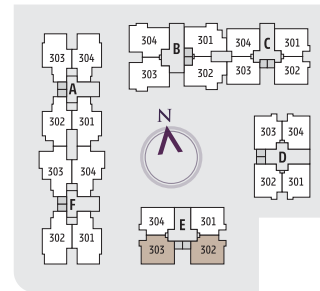

3 BHK
UNIT - A1



3 BHK
UNIT · B

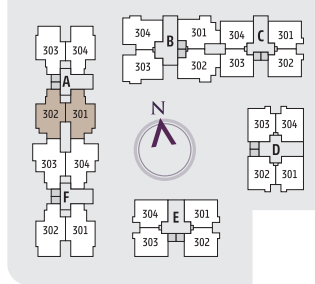

3 BHK
UNIT · D

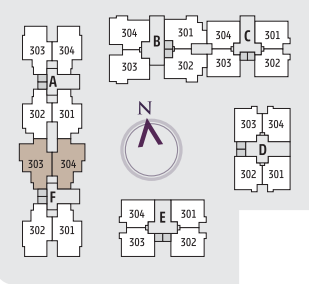

3 BHK
UNIT · C

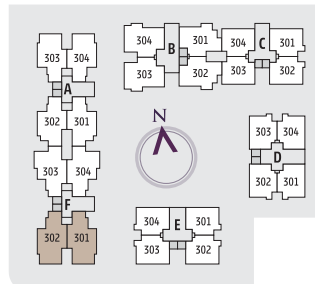

3 BHK
UNIT - E

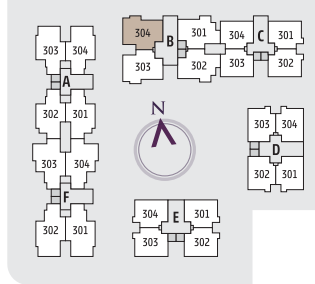

3 BHK
UNIT - F

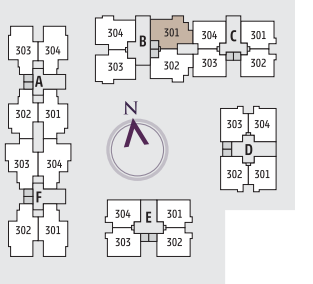

3 BHK
UNIT - E1

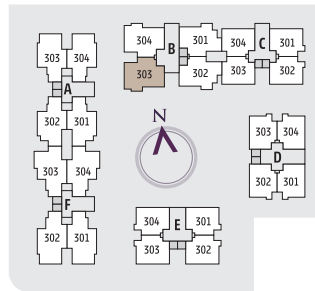

3 BHK
UNIT - F1





THE FACTS

WALL FINISH

INTERNAL : SMOOTH FINISH MALA PLASTER WITH PUTTY
EXTERNAL : DOUBLE COAT SAND FACED PLASTER OR TEXTURE FINISH.

FLOORING

· VITRIFIED TILES FLOORING IN ALL ROOM.

KITCHEN

· STANDING POLISHED NATURAL GRANITE KITCHEN PLATFORM WITH SINK &
· GLAZED TILES DADO ABOVE THE PLATFORM UP TO LINTEL LEVEL.

DOORS

· DECORATIVE MAIN DOOR HAVING LOCK OF REPUTED COMPANY.
· INTERNAL DOORS OF LAMINATED FLUSH DOORS OR COLOURED FLUSH DOOR.

WINDOWS

· ALUMINIUM ANODIZED SECTION SLIDING WINDOWS WITH GLASS & STONE JAMBS.

TOILET

· CERAMIC TILES FLOORING IN ALL TOILETS, GLAZED TILES DADO UP TO LINTEL LEVEL.

PLUMBING

· CONCEALED PLUMBING OF GOOD QUALITY UPVC & CPVC PIPES, C.P. FITTINGS &
· SANITARY WARE OF REPUTED BRANDS.

ELECTRIFICATION

· SINGLE PHASE METER + MCB & ELCB TRIPPER WITH CONCEALED WIRING
· WITH ADEQUATE POINTS WITH QUALITY FITTINGS.

PAINT

· EXTERIOR PAINTING OF ACRYLIC PAINT.
· INTERNAL WALLS DOUBLE COAT PUTTY FINISH.

LIFTS

· FINE QUALITY FULLY AUTOMATIC LIFTS.

OUR LANDMARK PROJECTS

KAVISHA
Urbania
2000+ sq.ft. Permissible

AT SOUTH BOPAL



C3
CELEBRATION
CITY CENTRE
retail & work spaces

AT SOUTH BOPAL



KAVISHA
CELEBRATIONS
2 & 3 BHK LIVING SPACE

AT SOUTH BOPAL



KAVISHA
PANORAMA
3 & 2 BHK HOMES WITH AN EDGE

AT SOUTH BOPAL



THE Canvas
3 | 4 | 5 BHK
LUXURY CANVAS & SHOPS

AT WAPA



KAVISHA
AMARA
2 & 3 BHK LIVING & SHOPS

AT SHELA



AWARDS & RECOGNITION

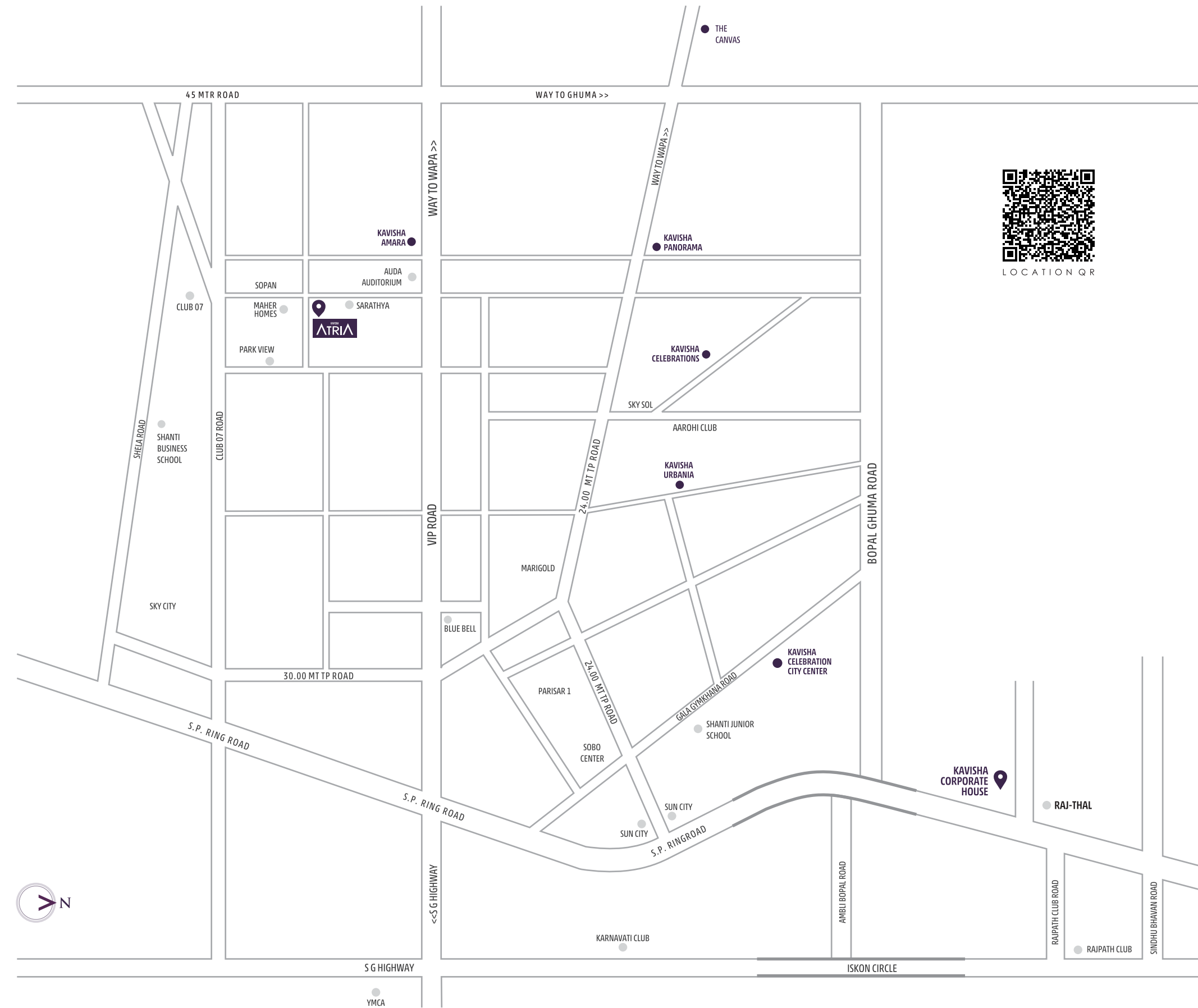

LOCATION QR



Terms & Conditions : • All the architectural and interior images in the brochure, are merely simulated interpretations using computer graphics to enhance the customer understanding and are not actual images. • The colour and general appearance of the flooring and wall tiles, sanitary ware & fittings, walls, ceilings, windows, doors, internal roads, trees, shrubbery etc. shown in the simulated computer graphics images are taken from the object libraries for the purpose of presentation and the prospective buyers of the concerned property are advised to refer to the contractor specifications mentioned in the brochure. Additional amenities and/or utilities not mentioned or shown in the brochure but may be required as per the law, should be deemed to be forming part of the project by the purchaser. • All Furniture including wardrobes, other sofa furnishings inter-alia curtains, mattresses, bed linen, upholstery etc., lights and other electrical fixtures and appliances like air conditioners, refrigerators, TVs, telephones, laptops etc., any of the equipment, household accessories inter-alia crockery and cutlery, rugs, carpets, decorative pieces and wall hangings, wall papers, utensils etc. apparels and all other consumable and movable items shown in the simulated images do not form part of the sale of any property by the developer. • All rights reserved with the developers to make any minor changes in the project and all the members shall abide by such changes. • GST Stamp duty, registration charges, or any other charges and taxes as & when levied by government or any of its body shall be borne by purchaser/buyer/legal possession holder. • This brochure is not to be treated as part of the legal document and is for an easy display of the project. • Subject to Ahmedabad Jurisdiction only. • The Brochure is for restricted private circulation only and is not to be considered as a legal document with obligations for specific performance. It is meant for the purpose of conceptual presentation only.



BORNTOBUILD!

#KAVISHACARES

SITE ADDRESS : KAVISHA ATRIA, BESIDES VISHWANATH SARATHYA
NEAR AUDA AUDITORIUM, OFF. 45 MTR MAIN ROAD, SHELA, AHMEDABAD

9016 1324 10 / 13 | sales@kavishacorp.com | KAVISHACORP.COM  

RERA NO. : PR/GJ/AHMEDABAD/SANAND/AUDA/MAA09500/181221 / WWW.GUJRERA.GUJARAT.GOV.IN